

NUTS AND FERRULES

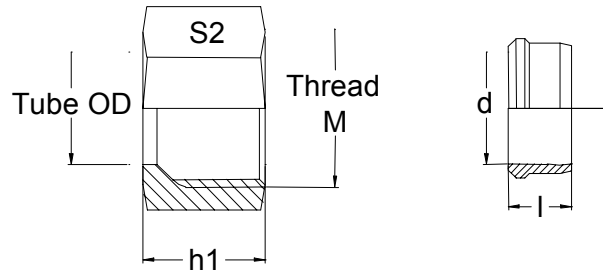

| | | | TUBE OD. | | | | | | FERRULE | |
|------------------------|-----------------------|------------------------|-----------|-----------|------|------|------|------|---------|------|
| METRIC SIZE TUBE | L | 250 Kg/cm ² | 6 | M12 X 1.5 | 14 | 15 | 6 | 9.5 | N6L | F6L |
| | | | 8 | M14 X 1.5 | 17 | 15 | 8 | 9.5 | N8L | F8L |
| | | | 10 | M16 X 1.5 | 19 | 16 | 10 | 10 | N10L | F10L |
| | | | 12 | M18 X 1.5 | 22 | 16 | 12 | 10 | N12L | F12L |
| | | | 15 | M22 X 1.5 | 27 | 17.5 | 15 | 10 | N15L | F15L |
| | | 160 Kg/cm ² | 18 | M26 X 1.5 | 32 | 18 | 18 | 10 | N18L | F18L |
| | | | 22 | M30 X 2 | 36 | 20.5 | 22 | 10.5 | N22L | F22L |
| | 100Kg/cm ² | 28 | M36 X 2 | 41 | 21 | 28 | 10.5 | N28L | F28L | |
| | | 35 | M45 X 2 | 50 | 24 | 35 | 13 | N35L | F35L | |
| | | 42 | M52 X 2 | 60 | 24 | 42 | 13.5 | N42L | F42L | |
| | H | 630 Kg/cm ² | 6 | M14 X 1.5 | 17 | 16 | 6 | 9.5 | N6H | F6H |
| | | | 8 | M16 X 1.5 | 19 | 16 | 8 | 9.5 | N8H | F8H |
| | | | 10 | M18 X 1.5 | 22 | 17.5 | 10 | 10 | N10H | F10H |
| | | | 12 | M20 X 1.5 | 24 | 18 | 12 | 10 | N12H | F12H |
| 14 | | | M22 X 1.5 | 27 | 20 | 14 | 10 | N14H | F14H | |
| 400 Kg/cm ² | | 16 | M24 X 1.5 | 30 | 21 | 16 | 10.5 | N16H | F16H | |
| | | 20 | M30 X 2 | 36 | 24 | 20 | 12.5 | N20H | F20H | |
| | | 25 | M36 X 2 | 46 | 26.5 | 25 | 12.5 | N25H | F25H | |
| 250 Kg/cm ² | | 30 | M42 X 2 | 50 | 29.5 | 30 | 13 | N30H | F30H | |
| | | 38 | M52 x 2 | 60 | 32.5 | 38 | 13.5 | N38H | F38H | |

S.D.INDUSTRIES.

An ISO 9001 : 2000 Company

Hydraulics, Pneumatics, Instrumentation Fittings, Manifolds & Valves

2/10, Singh Industrial Estate, Ram Mandir Road, Goregaon (W), Mumbai-400 104, India

◆ Phone: +91 22 28724724, +91 22 28738511 ◆ Fax: +91 22 28752130

◆ Email: sdind@vsnl.com ◆ www.sdinds.com

"We Deliver Confidence Through Quality Products."

NUTS AND FERRULES

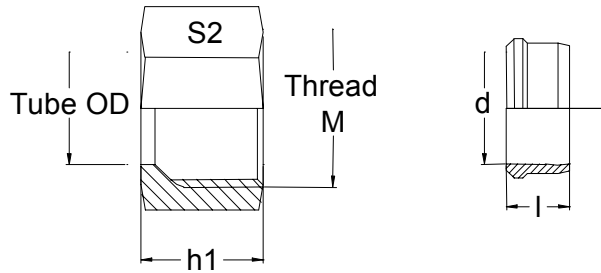

| | | TUBE OD. | | | | | | PART NO. | |
|-------------------|----------|----------|-----------|------|------|------|------|----------|---------|
| | | | | | | | | | FERRULE |
| INCH SIZE OD TUBE | 6000 PSI | 1/4" | M14 X 1.5 | 0.67 | 0.63 | 0.25 | 0.36 | 4N | 4F |
| | | 3/8" | M16 X 1.5 | 0.75 | 0.63 | 0.38 | 0.39 | 6N | 6F |
| | | 1/2" | M20 X 1.5 | 0.94 | 0.66 | 0.50 | 0.39 | 8N | 8F |
| | | 3/4" | M27 X 1.5 | 1.25 | 0.78 | 0.75 | 0.47 | 12N | 12F |
| | | 1" | M36 X 2 | 1.75 | 0.98 | 1.01 | 0.47 | 16N | 16F |
| | 3000 PSI | 1 1/4" | M42 X 2 | 1.97 | 1.16 | 1.26 | 0.51 | 20N | 20F |
| | | 1 1/2" | M52 x 2 | 2.36 | 1.26 | 1.50 | 0.53 | 24N | 24F |
| 2000 PSI | 2" | M60 X 2 | 2.75 | 1.28 | 2.01 | 0.59 | 32N | 32F | |
| NOM. BORE TUBE | 6000 PSI | 1/4" | M22 X 1.5 | 1.06 | 0.74 | 0.53 | 0.39 | 4NNB | 4FNB |
| | | 3/8" | M26 X 1.5 | 1.25 | 0.78 | 0.67 | 0.43 | 6NNB | 6FNB |
| | | 1/2" | M30 X 1.5 | 1.42 | 0.94 | 0.84 | 0.45 | 8NNB | 8FNB |
| | | 3/4" | M36 X 2 | 1.61 | 0.98 | 1.06 | 0.49 | 12NNB | 12FNB |
| | 3000 PSI | 1" | M45 X 2 | 2.05 | 1.16 | 1.33 | 0.51 | 16NNB | 16FNB |
| | | 1 1/4" | M52 X 2 | 2.36 | 1.18 | 1.68 | 0.53 | 20NNB | 20FNB |
| | 2000 PSI | 1 1/2" | M60 X 2 | 2.75 | 1.26 | 1.91 | 0.59 | 24NNB | 24FNB |

S.D.INDUSTRIES.

An ISO 9001 : 2000 Company

Hydraulics, Pneumatics, Instrumentation Fittings, Manifolds & Valves

2/10, Singh Industrial Estate, Ram Mandir Road, Goregaon (W), Mumbai-400 104, India

◆ Phone: +91 22 28724724, +91 22 28738511 ◆ Fax: +91 22 28752130

◆ Email: sdind@vsnl.com ◆ www.sdinds.com

"We Deliver Confidence Through Quality Products."