

**MALE BRANCH TEE (STUD END TAPER THREAD)
METRIC OD TUBES X NPT THREAD-N**

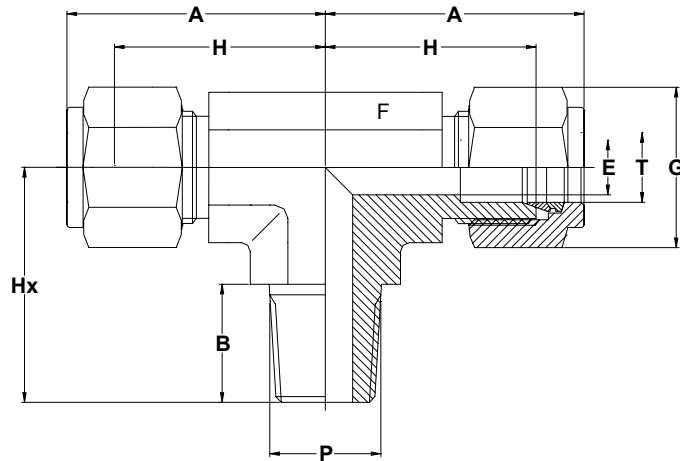

	P	A	B	E	F	G	H	Hx	PART NO.
mm	NPT (M)	mm	mm	mm	mm	mm	mm	mm	
3	1/8	23.6	9.6	2.4	11	11	17	17.8	D-MBT3-N2
3	1/4	24.6	14.3	2.4	14	11	18	23.4	D-MBT3-N4
6	1/8	27	9.6	4.8	14	14	19.6	18.8	D-MBT6-N2
6	1/4	27	14.3	4.8	14	14	19.6	23.4	D-MBT6-N4
6	3/8	29.8	14.3	4.8	17	14	22.4	26.2	D-MBT6-N6
8	1/4	28.8	14.3	6.3	14	16	21.3	24.4	D-MBT8-N4
8	3/8	30.6	14.3	6.3	17	16	23.1	26.2	D-MBT8-N6
8	1/2	32.6	19.1	6.3	22	16	25.1	33	D-MBT8-N8
10	1/4	31.5	14.3	7.1	17	19	23.9	26.2	D-MBT10-N4
10	3/8	31.5	14.3	7.9	17	19	23.9	26.2	D-MBT10-N6
10	1/2	33.5	19.1	7.9	22	19	25.9	33	D-MBT10-N8
12	1/4	36	14.3	7.1	22	22	25.9	26.2	D-MBT12-N4
12	3/8	36	14.3	9.5	22	22	25.9	28.2	D-MBT12-N6
12	1/2	36	19.1	9.5	22	22	25.9	33	D-MBT12-N8
16	1/2	38	19.1	11.3	24	25	27.9	35.1	D-MBT16-N8
25	3/4	49.1	19.1	15.8	35	38	36.8	41.7	D-MBT25-N12
25	1	49.1	23.8	21.8	35	38	36.8	46.5	D-MBT25-N16

NOTE:

THE PART NUMBERS GIVEN HERE ARE FOR TAPER MALE BRANCH TEE. CORRESPONDING PART NUMBERS FOR TAPER MALE RUN TEE CAN BE OBTAINED BY SUBSTITUTING 'MRT' FOR 'MBT'.

S.D.INDUSTRIES.

An ISO 9001 : 2000 Company

Hydraulics, Pneumatics, Instrumentation Fittings, Manifolds & Valves

2/10, Singh Industrial Estate, Ram Mandir Road, Goregaon (W), Mumbai-400 104, India

◆ Phone: +91 22 28791745 / 55 / 56 ◆ Fax: +91 22 28752130

◆ Email: sdind@vsnl.com ◆ www.sdindustries.com

"We Deliver Confidence Through Quality Products."

**MALE BRANCH TEE (STUD END TAPER THREAD)
INCH OD TUBES X NPT THREAD-N**

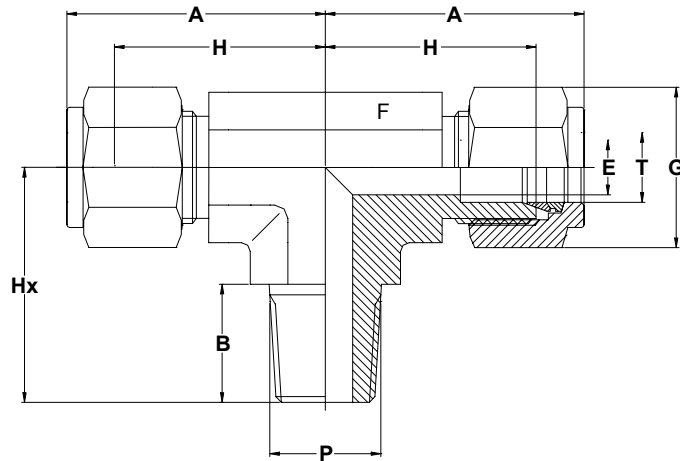

TUBE OD - T	P	A	B	E	F	G	H	Hx	PART NO.
inch	NPT (M)	mm	mm	mm	mm	mm	mm	mm	
1/8	1/8	23.6	9.6	2.4	11	11	17	17.8	2D-MBTN
1/8	1/4	24.6	14.3	2.4	14	11	18	23.4	2-4D-MBTN
1/4	1/8	26.9	9.6	4.8	14	14	19.6	18.8	4-2D-MBTN
1/4	1/4	26.9	14.3	4.8	14	14	19.6	23.4	4D-MBTN
1/4	3/8	29.7	14.3	4.8	17	14	22.4	26.2	4-6D-MBTN
1/4	2/4	31.8	19.1	4.8	22	14	24.4	33	4-8D-MBTN
3/8	1/4	30.5	14.3	7.1	17	17	23.1	25.4	6-4D-MBTN
3/8	3/8	31.2	14.3	7.1	17	17	23.9	26.2	6D-MBTN
3/8	1/2	33	19.1	7.1	22	17	25.9	33	6-8D-MBTN
1/2	1/4	36	14.3	4.8	22	22	25.9	28.2	8-4D-MBTN
1/2	3/8	36	14.3	9.6	22	22	25.9	28.2	8-6D-MBTN
1/2	1/2	36	19.1	10.4	22	22	25.9	33	8D-MBTN
5/8	1/2	38.1	19.1	11.9	22	25	27.9	35	10-8D-MBTN
3/4	1/2	39.9	19.1	11.9	27	29	29.7	36.8	12-8D-MBTN
3/4	3/4	39.9	19.1	15.8	27	29	29.7	36.8	12D-MBTN
1	3/4	49	19.1	15.8	35	38	36.8	41.6	16-12D-MBTN
1	1	49	23.8	22.3	35	38	36.8	46.5	16D-MBTN

NOTE:
THE PART NUMBERS GIVEN HERE ARE FOR TAPER MALE BRANCH TEE. CORRESPONDING PART NUMBERS FOR TAPER MALE RUN TEE CAN BE OBTAINED BY SUBSTITUTING 'MRT' FOR 'MBT'.

S.D.INDUSTRIES.

An ISO 9001 : 2000 Company

Hydraulics, Pneumatics, Instrumentation Fittings, Manifolds & Valves

2/10, Singh Industrial Estate, Ram Mandir Road, Goregaon (W), Mumbai-400 104, India

◆ Phone: +91 22 28791745 / 55 / 56 ◆ Fax: +91 22 28752130

◆ Email: sdind@vsnl.com ◆ www.sdindustries.com

"We Deliver Confidence Through Quality Products."