

**MALE ELBOW (STUD END TAPER THREAD)
METRIC OD TUBES X NPT THREAD-N**

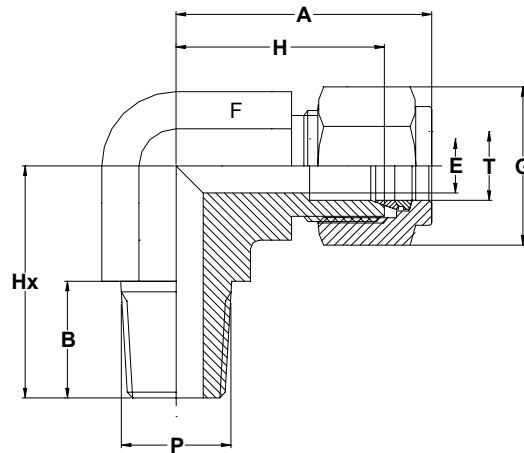

	P	A	B	E	F	G	H	Hx	PART NO.
mm	NPT (M)	mm	mm	mm	mm	mm	mm	mm	
3	1/8	23.6	9.6	2.4	11	11	17	17.8	D-ME3-N2
3	1/4	24.6	14.3	2.4	14	11	18	23.4	D-ME3-N4
6	1/8	27	9.6	4.8	14	14	19.6	18.8	D-ME6-N2
6	1/4	27	14.3	4.8	14	14	19.6	23.4	D-ME6-N4
6	3/8	29.8	14.3	4.8	17	14	22.4	26.2	D-ME6-N6
6	1/2	31.8	19.1	4.8	22	14	24.4	33	D-ME6-N8
8	1/8	28.8	9.6	4.8	14	16	21.3	19.8	D-ME8-N2
8	1/4	28.8	14.3	6.3	14	16	21.3	24.4	D-ME8-N4
8	3/8	30.6	14.3	6.3	17	16	23.1	26.2	D-ME8-N6
8	1/2	32.6	19.1	6.3	22	16	25.1	33	D-ME8-N8
10	1/4	31.5	14.3	7.1	17	19	23.9	26.2	D-ME10-N4
10	3/8	31.5	14.3	7.9	17	19	23.9	26.2	D-ME10-N6
10	1/2	33.5	19.1	7.9	22	19	25.9	33	D-ME10-N8
12	1/4	36	14.3	7.1	22	22	25.9	26.2	D-ME12-N4
12	3/8	36	14.3	9.5	22	22	25.9	28.2	D-ME12-N6
12	1/2	36	19.1	9.5	22	22	25.9	33	D-ME12-N8
15	1/2	38	19.1	11.9	24	25	27.9	35.1	D-ME15-N8
16	1/2	38	19.1	11.9	24	25	27.9	35.1	D-ME16-N8
16	3/4	39.8	19.1	11.9	24	25	29.7	36.8	D-ME16-N12
22	3/4	44.6	19.1	15.9	35	32	34.5	41.7	D-ME22-N12
22	1	44.6	23.9	18.3	35	32	34.5	46.5	D-ME22-N16
25	3/4	49.1	19.1	19.9	35	38	36.8	41.7	D-ME25-N12
25	1	49.1	23.9	21.8	35	38	36.8	46.5	D-ME25-N16

S.D.INDUSTRIES.

An ISO 9001 : 2000 Company

Hydraulics, Pneumatics, Instrumentation Fittings, Manifolds & Valves

2/10, Singh Industrial Estate, Ram Mandir Road, Goregaon (W), Mumbai-400 104, India

◆ Phone: +91 22 28791745 / 55 / 56 ◆ Fax: +91 22 28752130

◆ Email: sdind@vsnl.com ◆ www.sdindustries.com

"We Deliver Confidence Through Quality Products."

**MALE ELBOW (STUD END TAPER THREAD)
INCH OD TUBES X NPT THREAD-N**

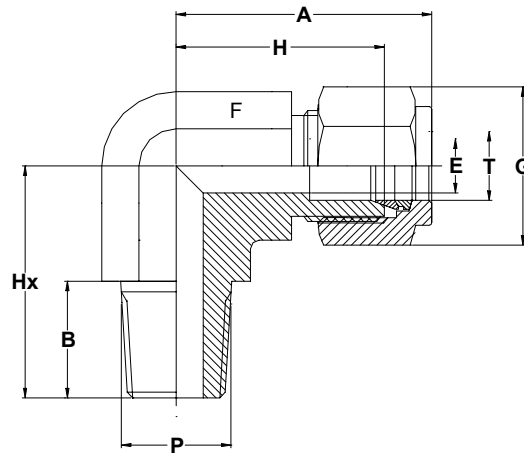

TUBE OD - T	P	A	B	E	F	G	H	Hx	PART NO.
inch	NPT (M)	mm	mm	mm	mm	mm	mm	mm	
1/8	1/8	23.6	9.6	2.4	11	11	17	17.8	2D-MEN
1/8	1/4	24.6	14.3	2.4	14	11	18	23.4	2-4D-MEN
1/4	1/8	26.9	10.4	4.8	14	14	19.6	19	4-2D-MEN
1/4	1/4	29.7	15	4.8	19	14	22.4	22.4	4D-MEN
1/4	3/8	31.8	15	4.8	22	14	24.4	22.4	4-6D-MEN
1/4	2/4	34.6	19.8	4.8	27	14	27.2	28.5	4-8D-MEN
3/8	1/8	30.5	9.6	4.8	14	17	23.2	19.1	6-2D-MEN
3/8	1/4	30.5	14.3	7.1	17	17	23.2	19.1	6-4D-MEN
3/8	3/8	31.2	15	7.1	17	17	23.9	22.4	6D-MEN
3/8	1/2	33.3	15	7.1	22	17	25.9	22.4	6-8D-MEN
1/2	1/4	36	14.3	4.8	22	22	25.9	28.2	8-4D-MEN
1/2	3/8	36	14.3	9.6	22	22	25.9	28.2	8-6D-MEN
1/2	1/2	36	19.1	10.4	22	22	25.9	33	8D-MEN
1/2	3/4	39.9	19.1	10.4	27	22	29.7	36.8	8-12D-MEN
3/4	1/2	39.9	19.1	11.9	27	29	29.7	36.8	12-8D-MEN
3/4	3/4	39.9	19.1	15.8	27	29	29.7	36.8	12D-MEN
1	3/4	49	19.1	15.8	35	38	36.8	41.6	16-12D-MEN
1	1	49	23.8	22.3	35	38	36.8	46.5	16D-MEN

S.D.INDUSTRIES.

An ISO 9001 : 2000 Company

Hydraulics, Pneumatics, Instrumentation Fittings, Manifolds & Valves

2/10, Singh Industrial Estate, Ram Mandir Road, Goregaon (W), Mumbai-400 104, India

◆ Phone: +91 22 28791745 / 55 / 56 ◆ Fax: +91 22 28752130

◆ Email: sdind@vsnl.com ◆ www.sdindustries.com

"We Deliver Confidence Through Quality Products."